

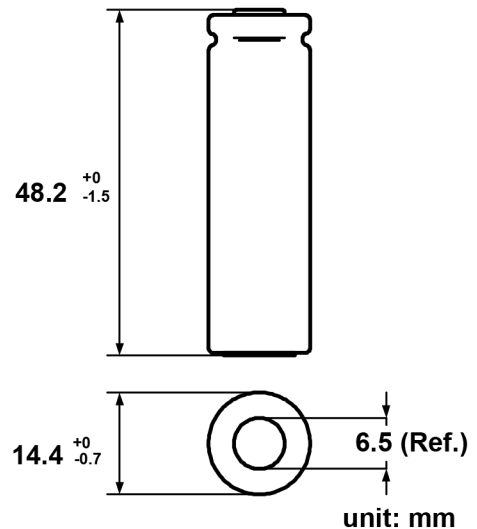

Model No.: GP125AAMT

Type	High Temperature Rechargeable Nickel Metal Hydride Cylindrical Cell
Nominal Dimension (with Sleeve)	$\Phi = 14.4\text{mm}$ $H = 48.2\text{mm}$
Applications	Long term standby use. Recommended discharge current: 125mA to 625mA
Nominal Voltage	1.2V
Capacity	Nominal: 1250mAh Minimum: 1250mAh Typical: 1280mAh When discharged at 250mA to 1.0V at 20°C
Charging Condition	Standard mode: 125mA for 16 hrs at 20°C Standby Intermittent mode: 125mA for 16hrs at 20°C then maintenance with 125mA for 1min/10mins.
Service Life	>500 cycles (IEC 61951-2)
Continuous Overcharge	Comply with IEC61951-2 Permanent Charge Endurance Test
Weight	24.0g
Internal Resistance	Average 23m Ω upon fully charged (Range 18-28m Ω) at 1000Hz
Max. Charging Voltage	1.6V at 125mA charging
Ambient Temperature Range	Charge: 0 to 50°C Discharging: -20 to 70°C Storage: -20 to 35°C Storage (1 week): -20 to 60°C



Low Rate Discharge

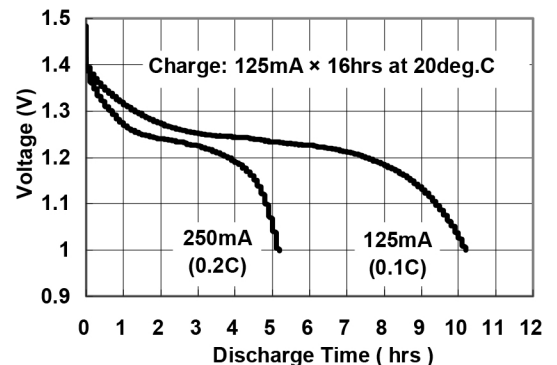

Charge & Discharge efficiency Vs. temp.

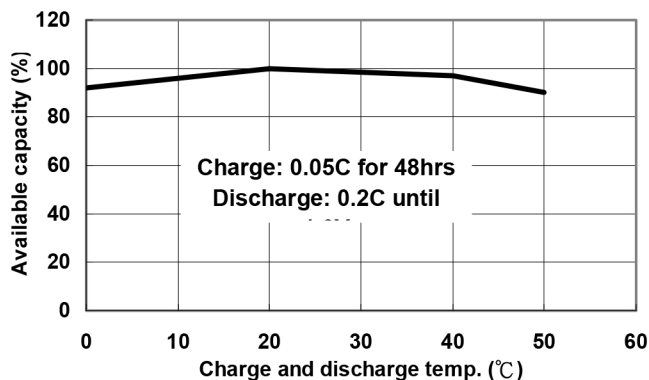

High Rate Discharge

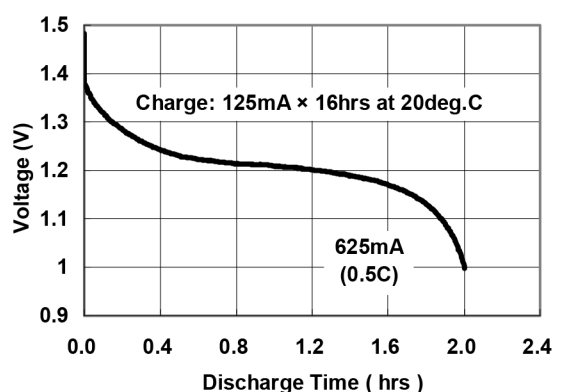

The information (subject to change without prior notice) contained in this document is for reference only and should not be used as a basis for product guarantee or warranty. For applications other than those described here, please consult your nearest GP Sales and Marketing Office or Distributors.

MRS6077 REV01